

Rainier Panels can be mitered to have a seamless wall.

Installation methods include z-clips or Cambio magnetic panels.

DETAIL A  
SCALE 3" = 1'-0"

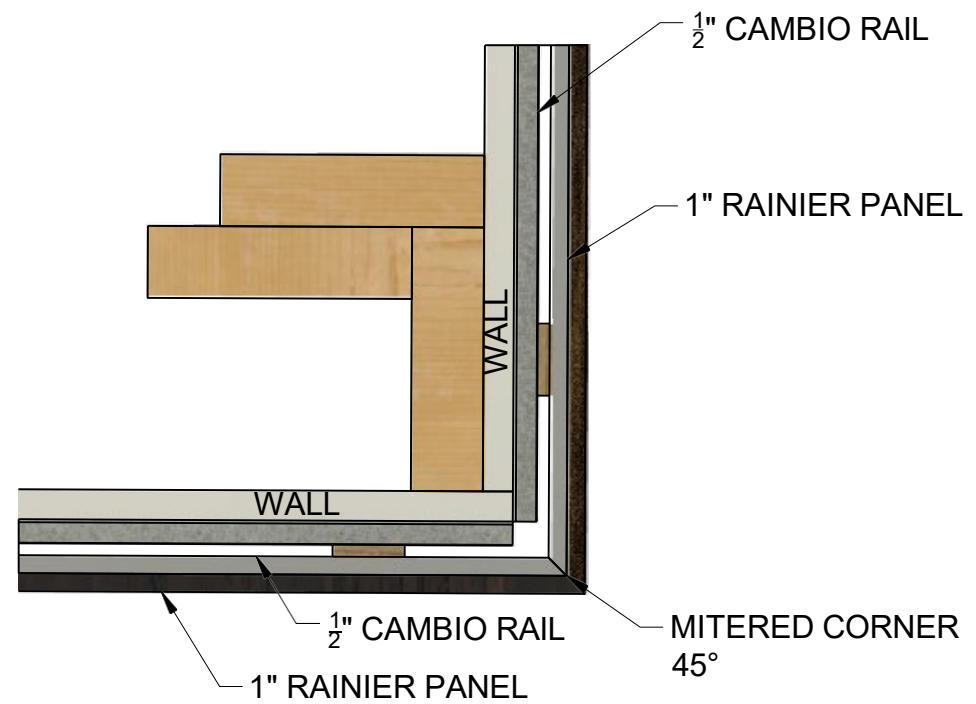

CLIENT

RAINIER CORNER DETAILS  
OUTSIDE CORNER  
MITERED

SHEET DATA	
DRAWN BY:	Scott Lavis Campbell
SCALE:	1" = 1'-0"
DATE:	02/17/2025
PROJECT:	Windfall / Cambio Drawings
SHEET NUMBER	
1/8	
OF	

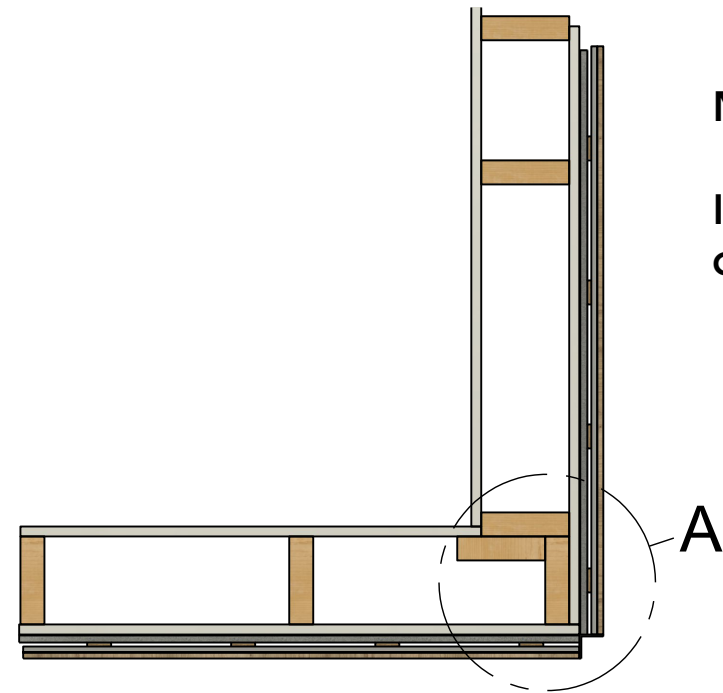
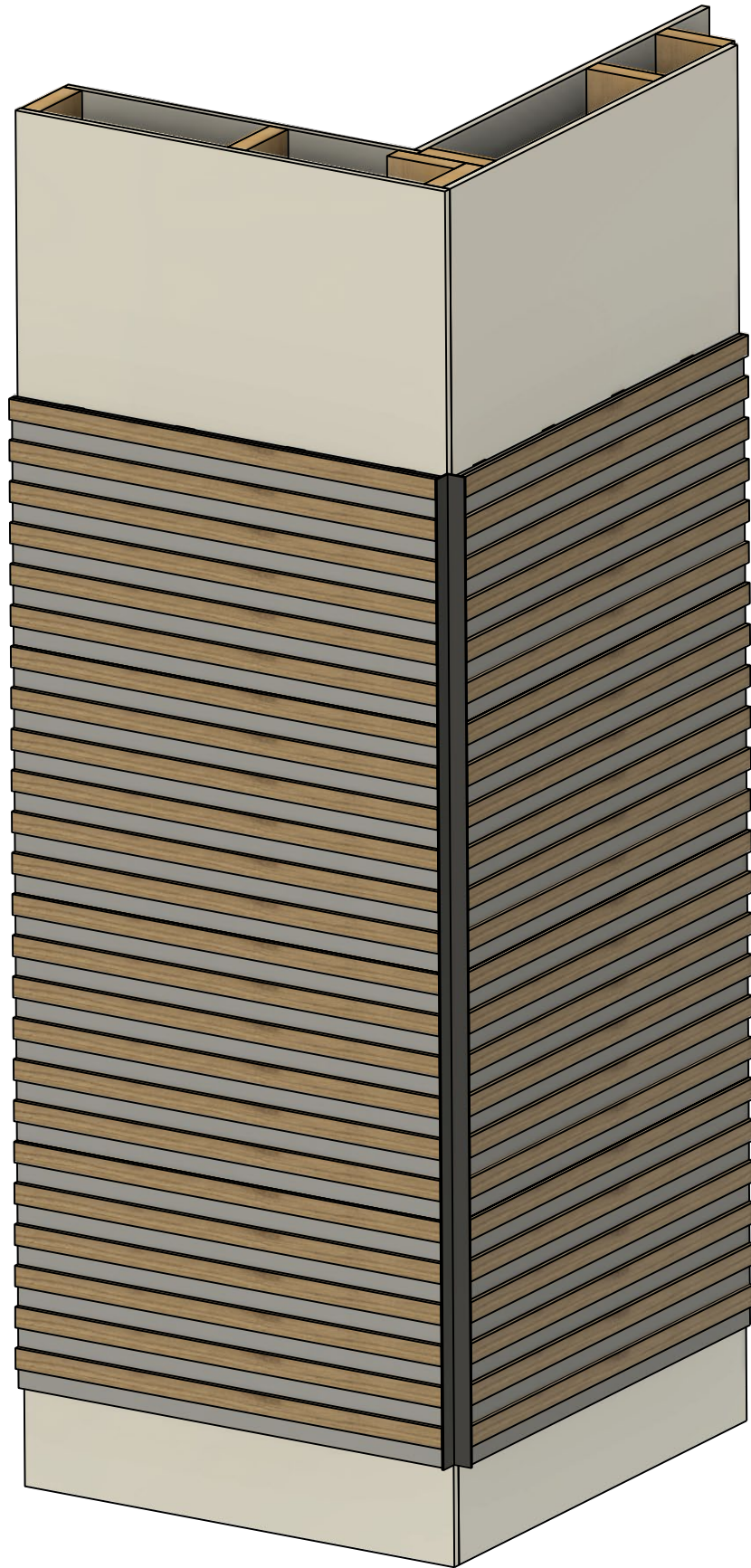

Metal angle can be used.

Installation methods include z-clips or Cambio magnetic panels.

**DETAIL A**  
SCALE 3"=1'-0"

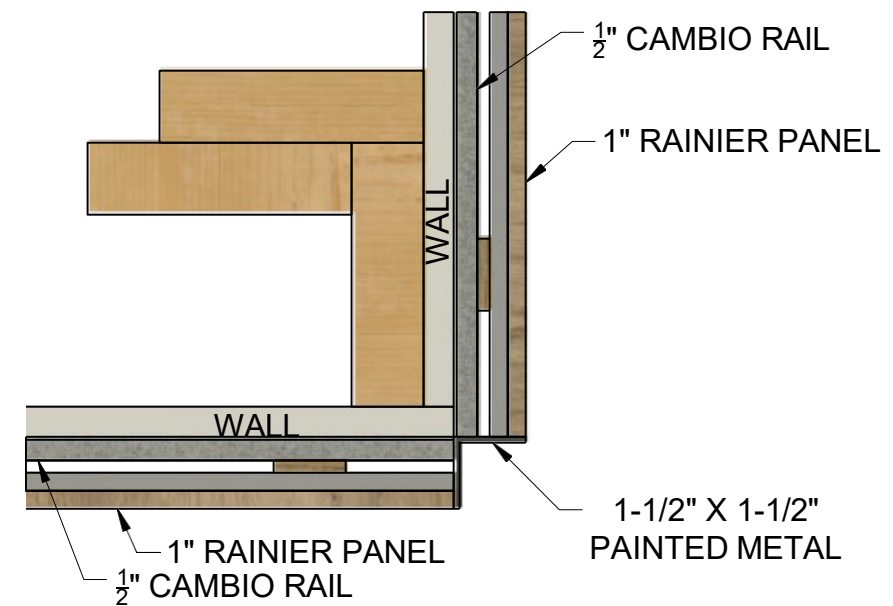

CLIENT

**RAINIER PANEL CORNER DETAILS**  
OUTSIDE CORNER  
PAINTED METAL ANGLE

SHEET DATA	
DRAWN BY:	Scott Lavis Campbell
SCALE:	1" = 1'-0"
DATE:	02/17/2025
PROJECT:	Rainier Panel Corner

SHEET NUMBER

**2/8**

OF

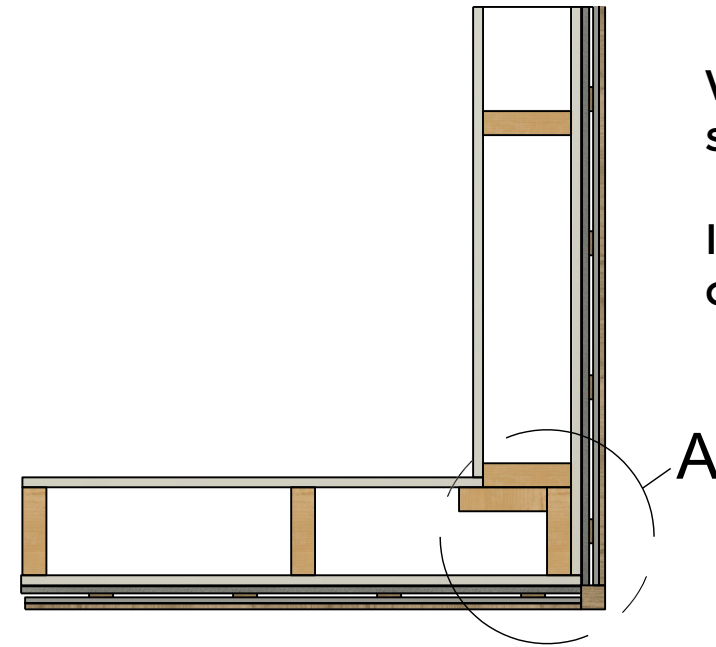
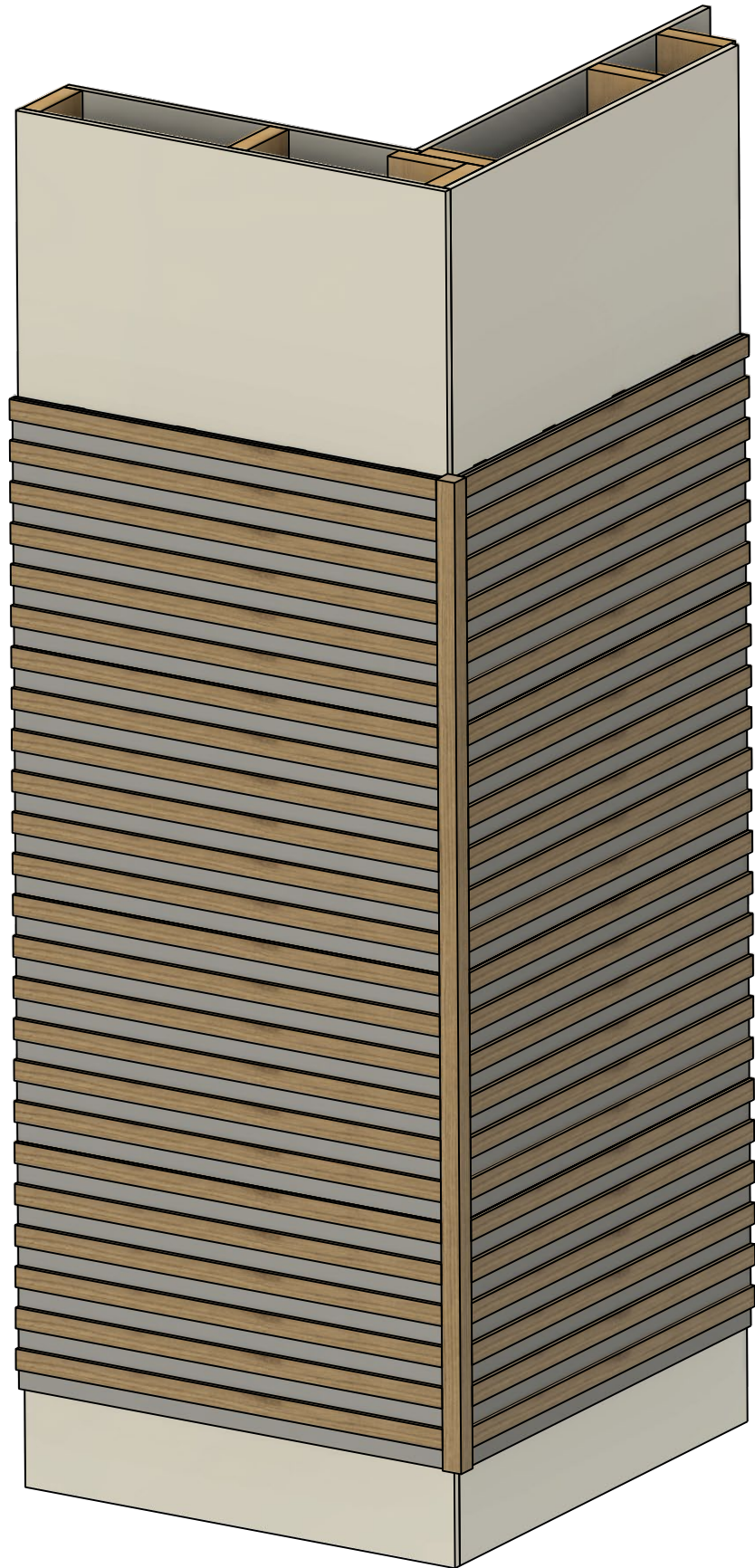

Wood corner block trim, can be stained to match sticks.

Installation methods include z-clip or Cambio magnetic panels.

**DETAIL A**  
SCALE 3" = 1'-0"

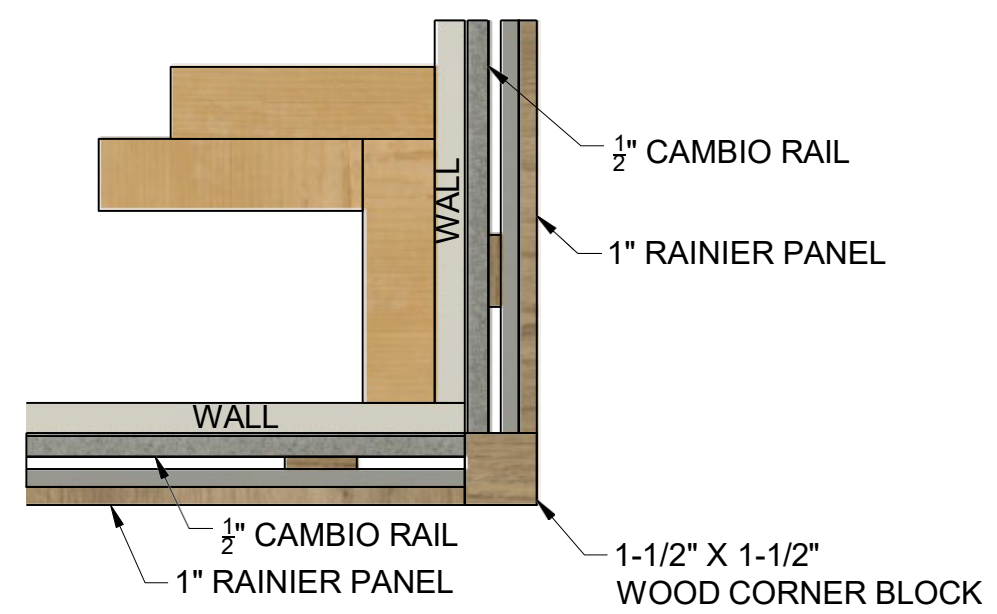

CLIENT

**RAINIER PANEL CORNER DETAILS**  
OUTSIDE CORNER  
WOOD CORNER TRIM

SHEET DATA	
DRAWN BY:	Scott Lavis Campbell
SCALE:	1" = 1'-0"
DATE:	02/17/2025
PROJECT:	Rainier Panel Corner
SHEET NUMBER	<b>3/8</b>
OF	

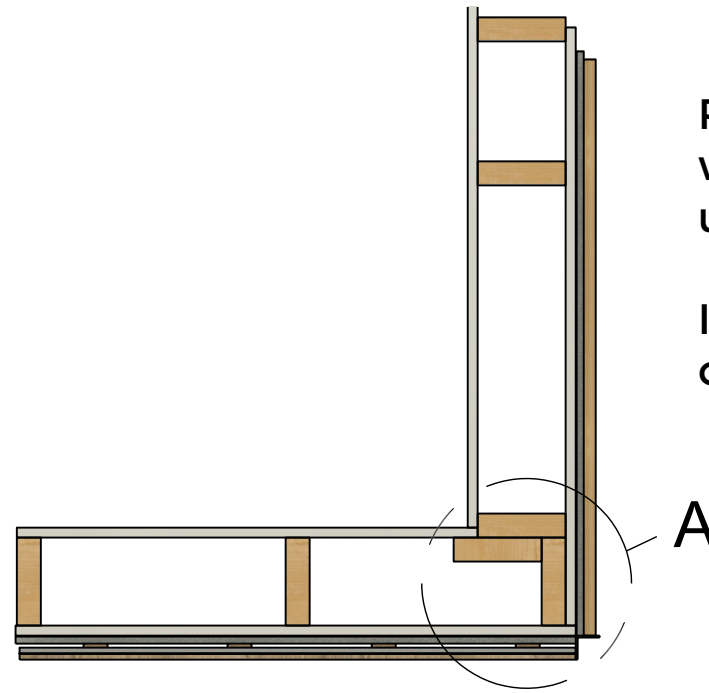
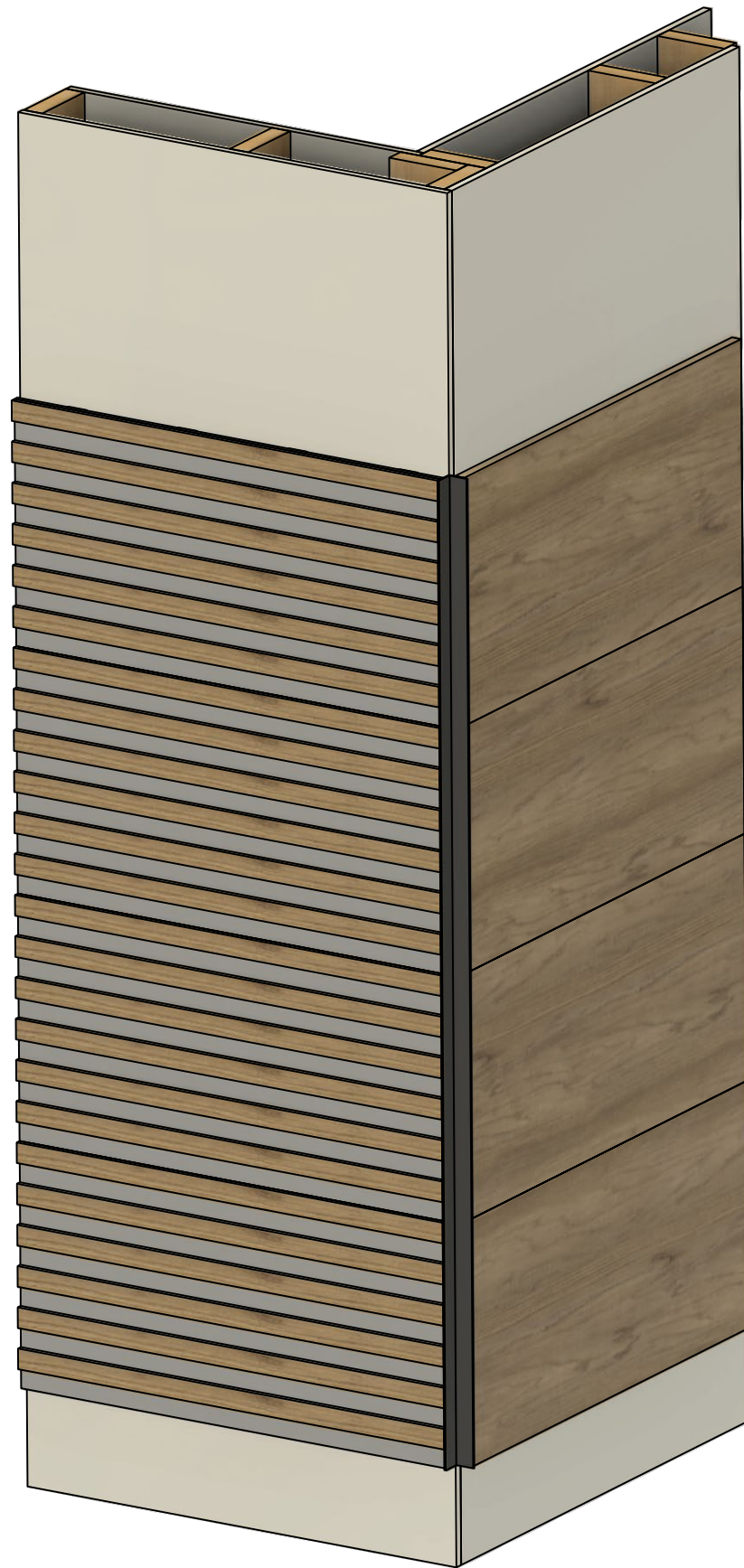

Rainier Panels can be installed with other panels. Shown here using metal angle.

Installation methods include z-clip or Cambio magnetic panels.

**DETAIL A**  
SCALE 3" = 1'-0"

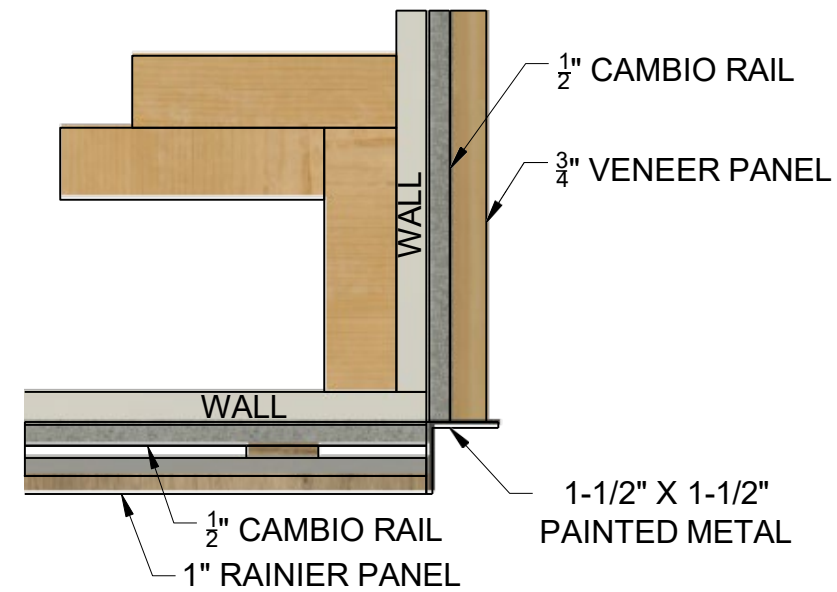

CLIENT

**RAINIER CORNER DETAILS**  
OUTSIDE CORNER - RAINIER TO VENEER PANEL  
PAINTED METAL ANGLE CORNER

SHEET DATA

DRAWN BY:  
Scott Lavis Campbell

SCALE:  
1" = 1'-0"

DATE:  
02/17/2025

PROJECT:  
Rainier Panel Corner

SHEET NUMBER

**4/8**

OF

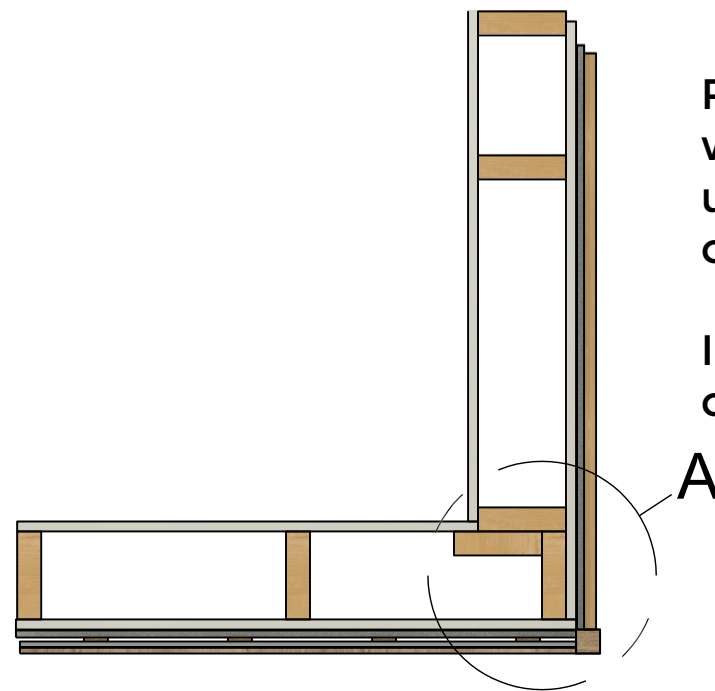
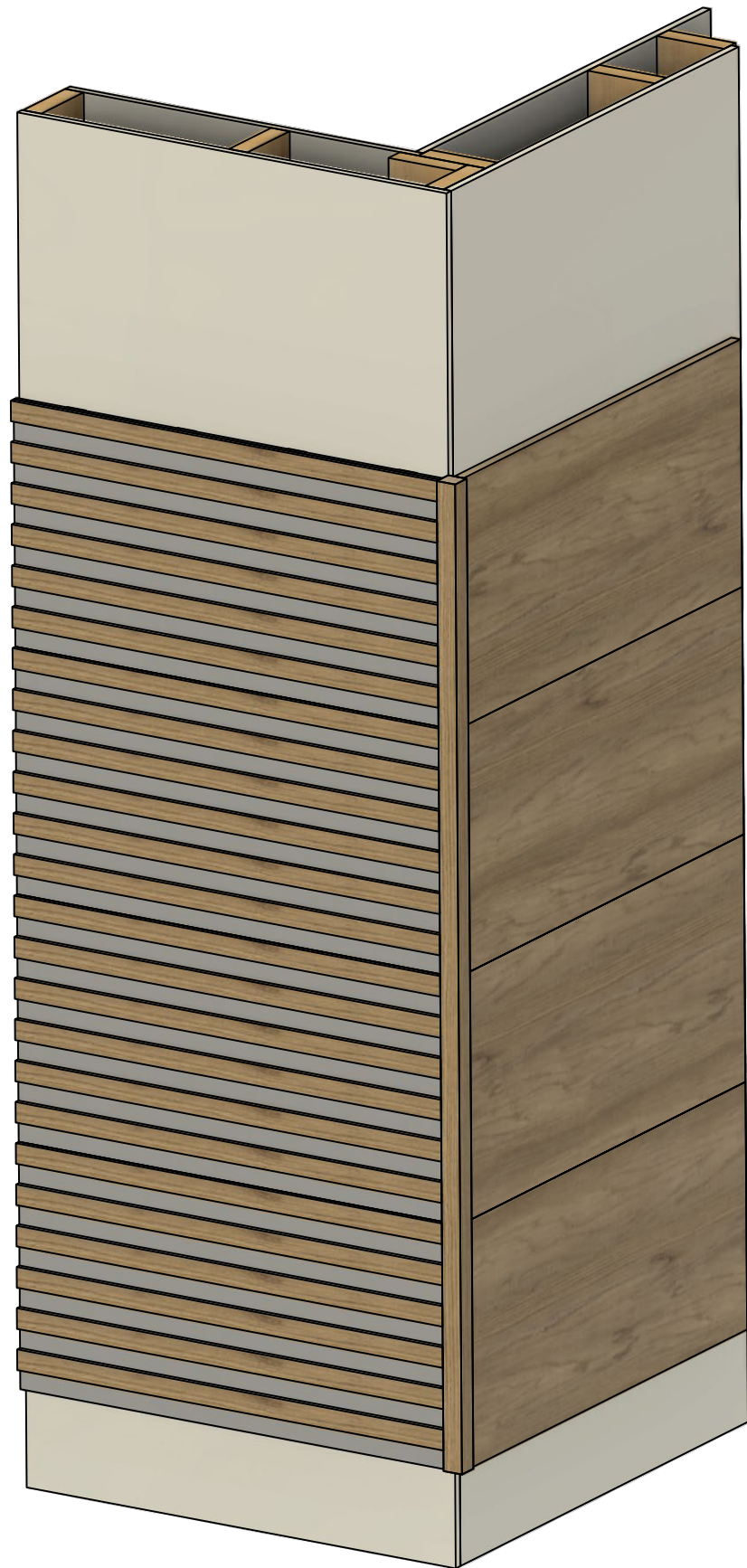

Rainier Panels can be installed with other panels. Shown here using wood corner trim. Wood can be stained to match sticks.

Installation methods include z-clip or Cambio magnetic panels.

**DETAIL A**  
SCALE 3"=1'-0"

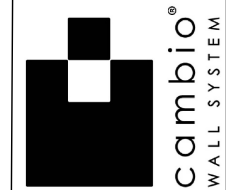
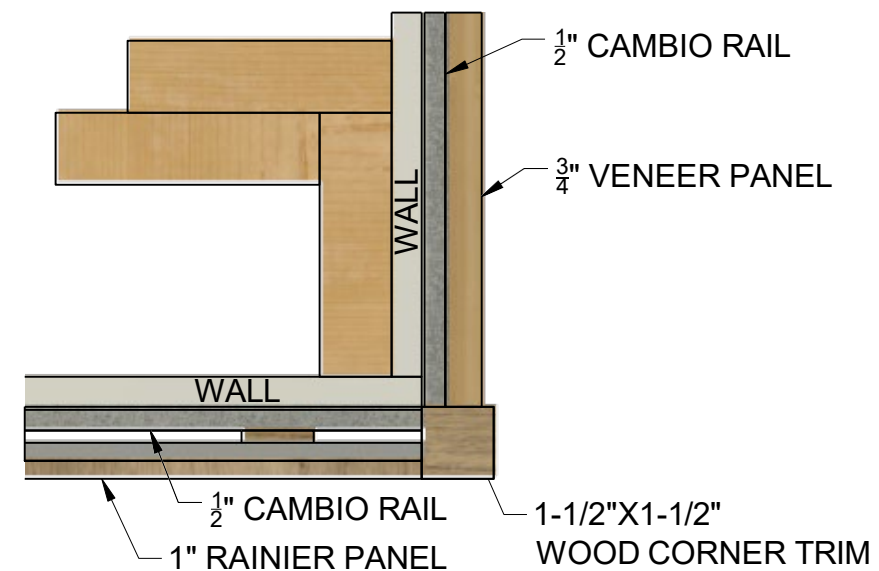

CLIENT  
**RAINIER PANEL CORNER DETAILS**  
OUTSIDE CORNER - RAINIER TO VENEER PANEL  
WOOD CORNER TRIM

SHEET DATA  
DRAWN BY: Scott Lavis Campbell  
SCALE: 1" = 1'-0"  
DATE: 02/17/2025  
PROJECT: Rainier Panel Corner

SHEET NUMBER  
**5/8**  
OF

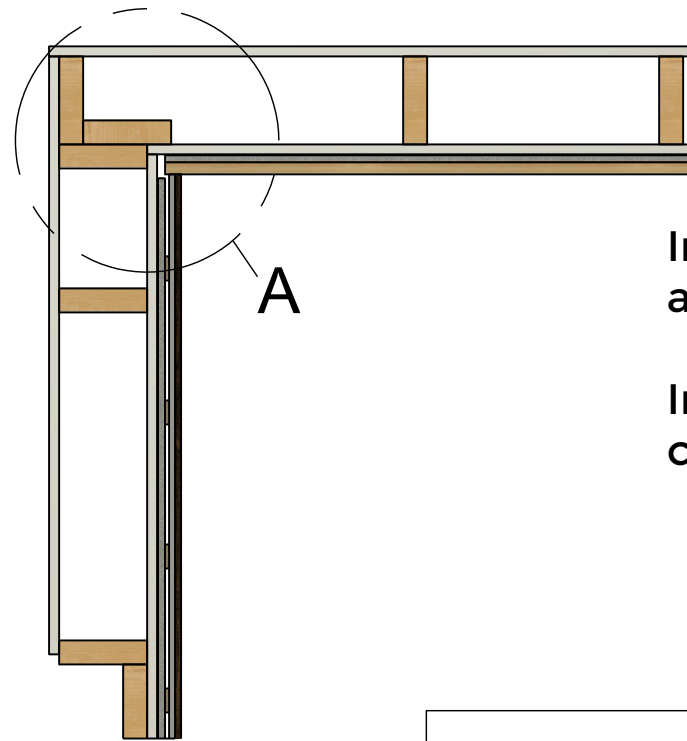
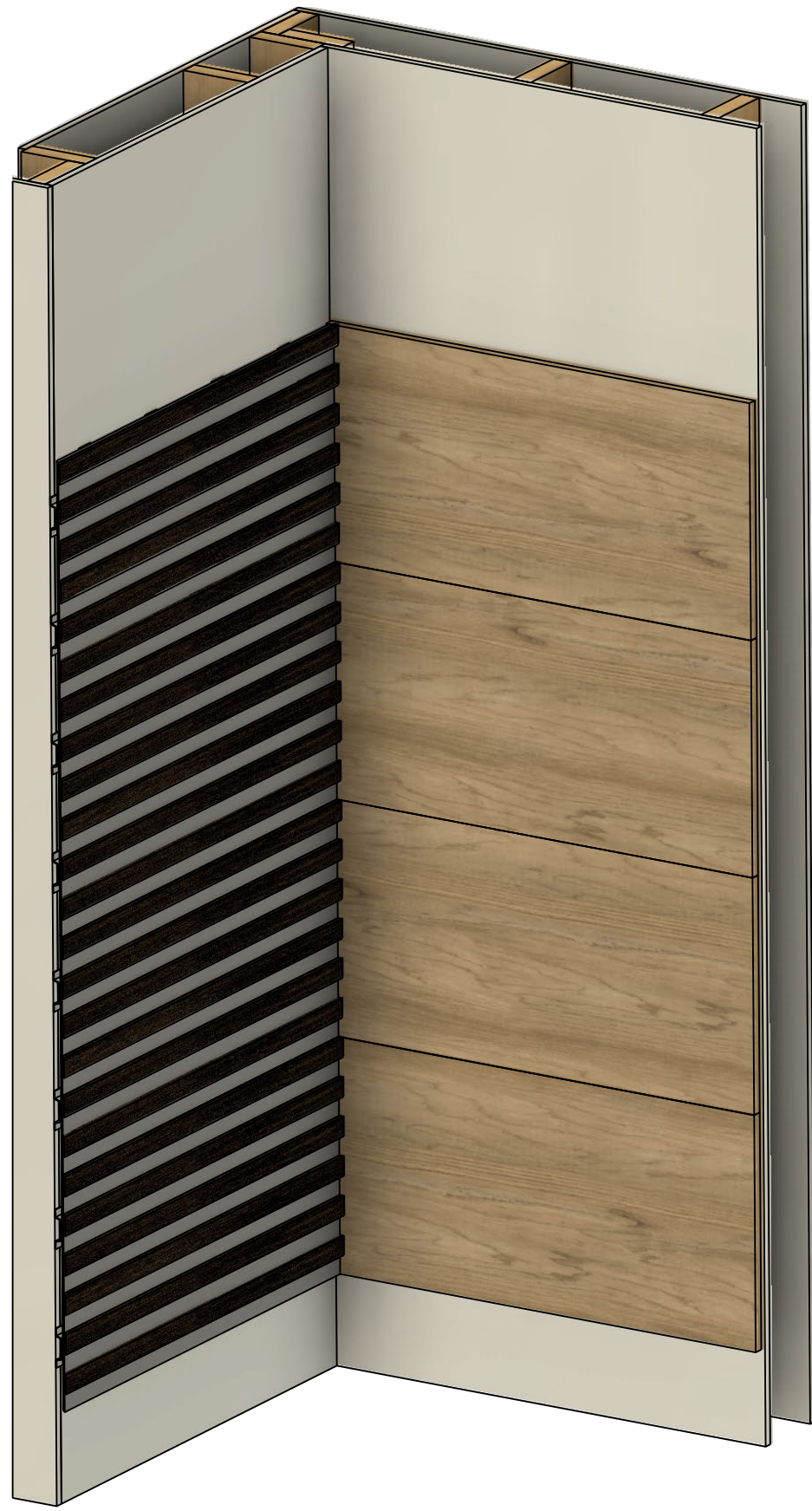

Inside corner using Rainier Panel and Veneer panels.

Installation methods include z-clip or Cambio magnetic panels.

DETAIL A  
SCALE 3"=1'-0"

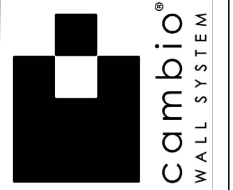
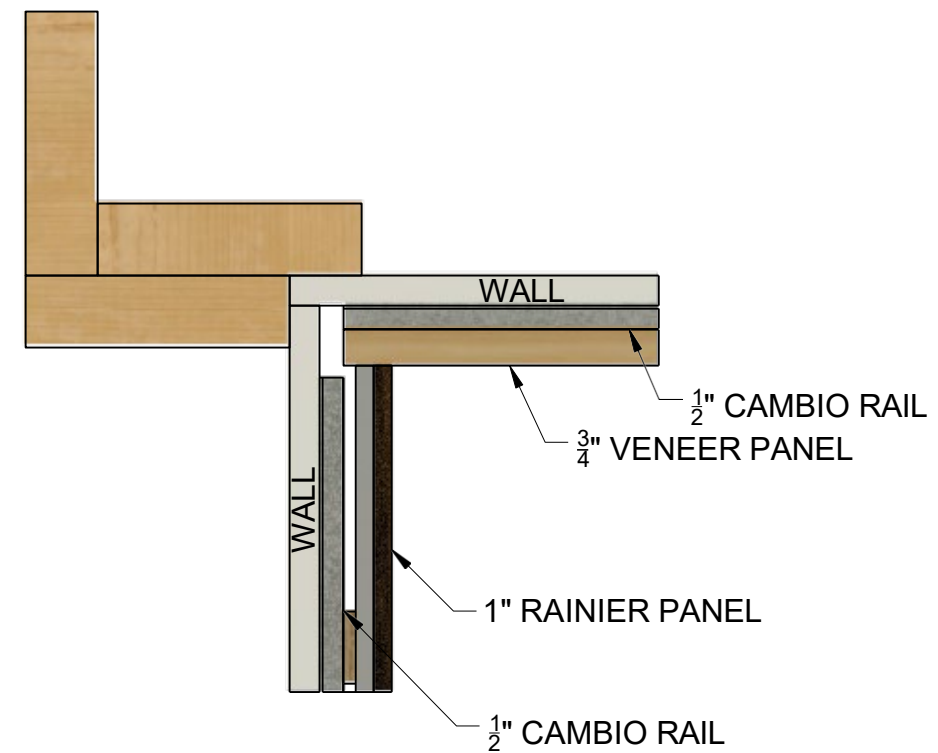

CLIENT  
RAINIER PANEL CORNER DETAILS  
RAINIER PANEL TO VENEER PANEL - INSIDE CORNER

SHEET DATA  
DRAWN BY: Scott Lavis Campbell  
SCALE: 1" = 1'-0"  
DATE: 02/17/2025  
PROJECT: Rainier Panel Corner

SHEET NUMBER  
6/8

OF

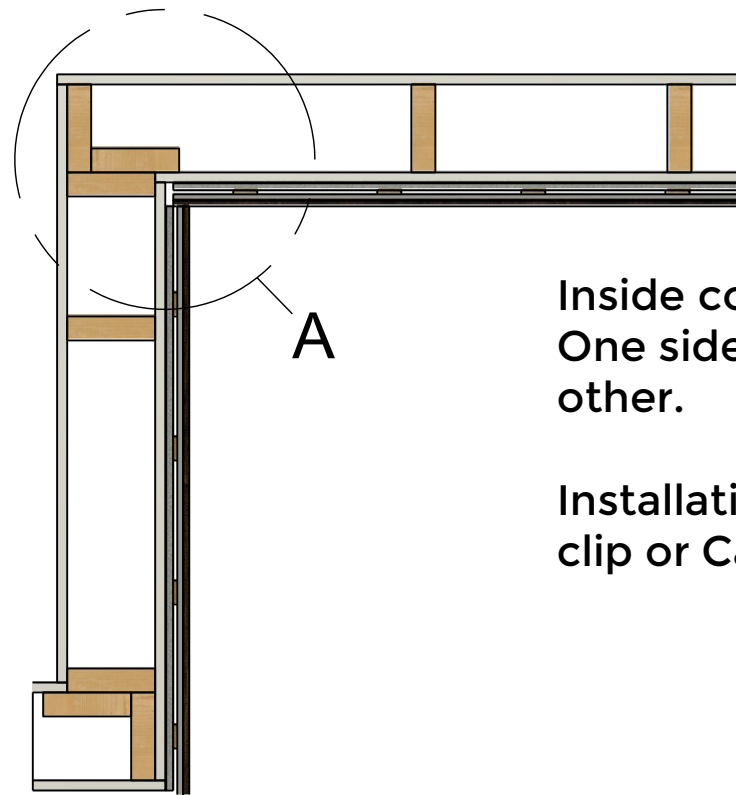

Inside corner using Rainier Panels.  
One side is tucked behind the other.

Installation methods include z-clip or Cambio magnetic panels.

**DETAIL A**  
**SCALE 3'=1'-0"**

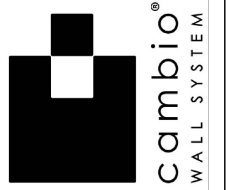
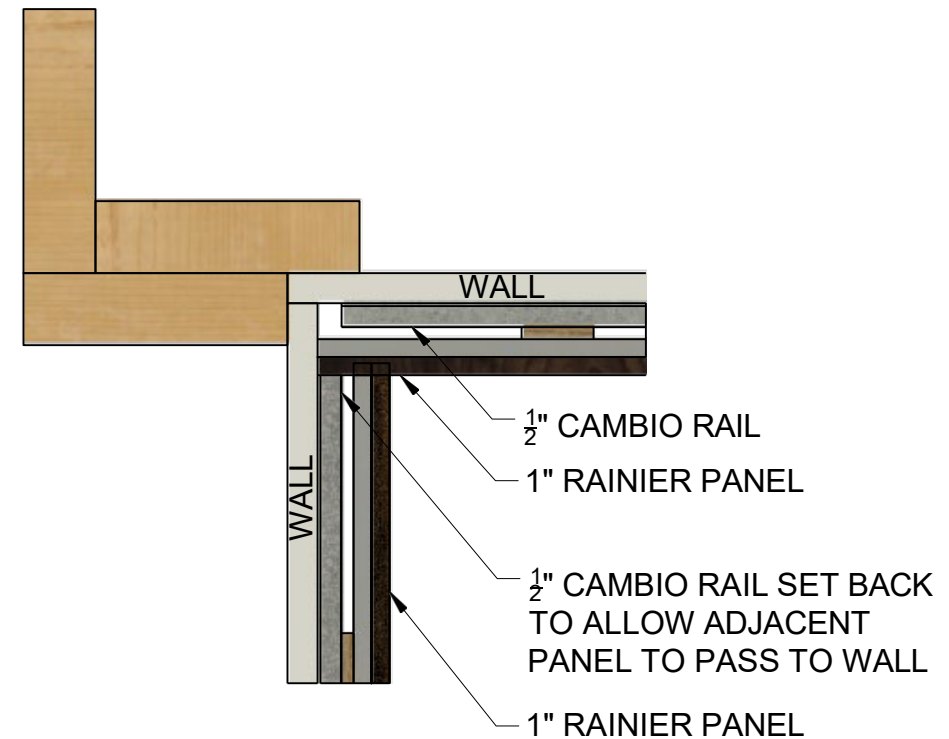

CLIENT  
**RAINIER PANEL CORNER DETAILS**  
RAINIER PANEL TO RAINIER PANEL - INSIDE CORNER  
DEEP OVERLAP

SHEET DATA  
DRAWN BY: Scott Lavis Campbell  
SCALE: 1" = 1'-0"  
DATE: 02/17/2025  
PROJECT: Rainier Panel Corner

SHEET NUMBER

**7/8**

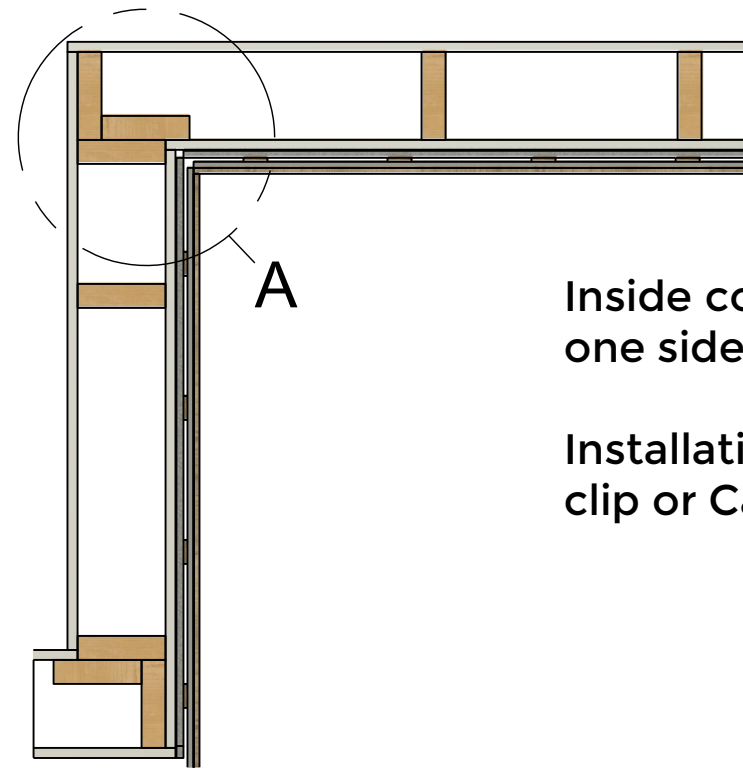
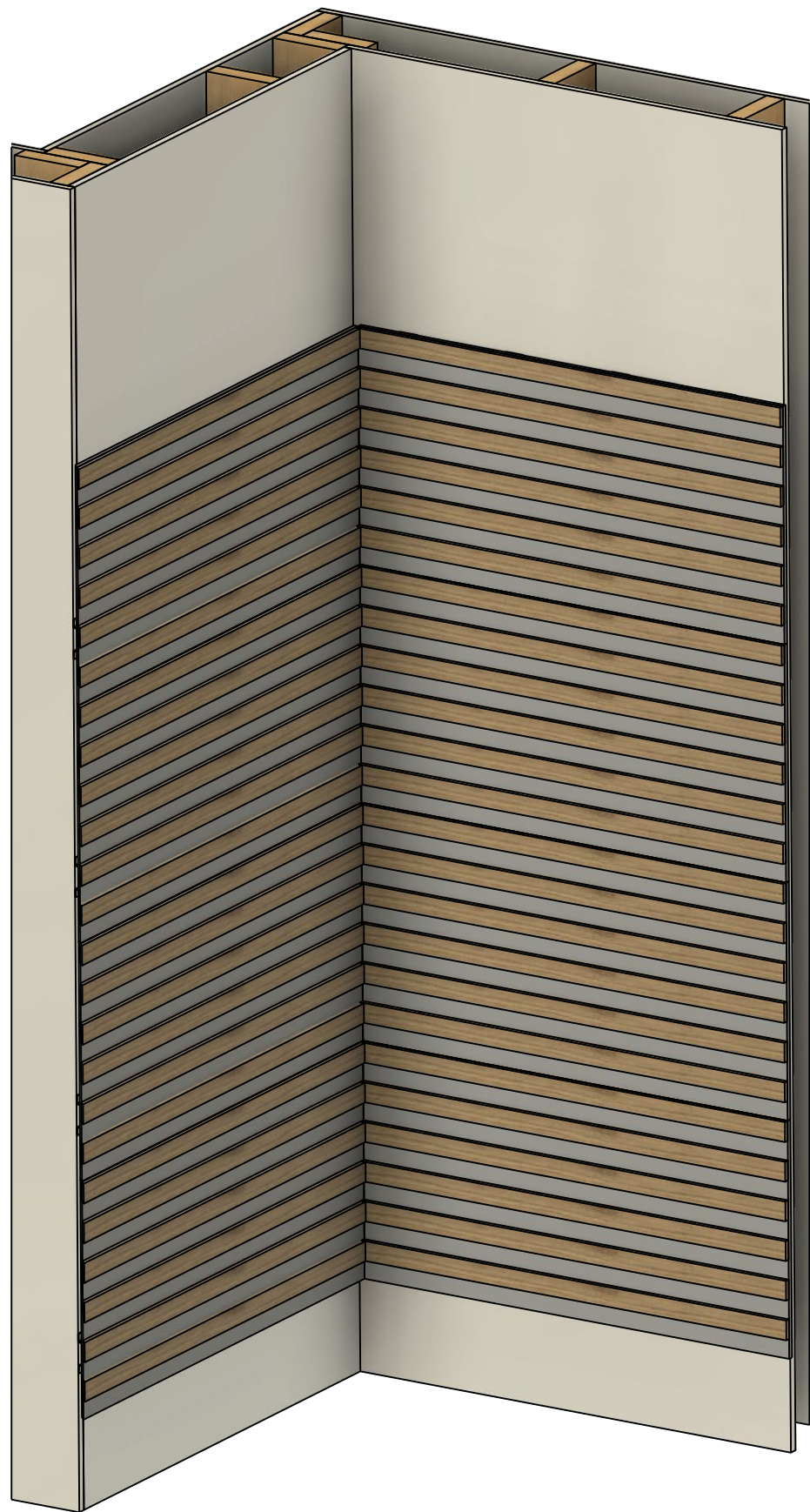

Inside corner using Rainier Panels  
one side of panels are cut back.

Installation methods include z-clip or Cambio magnetic panels.

**DETAIL A**  
**SCALE 3"=1'-0"**

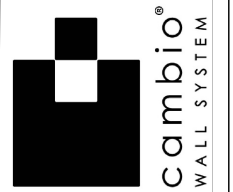
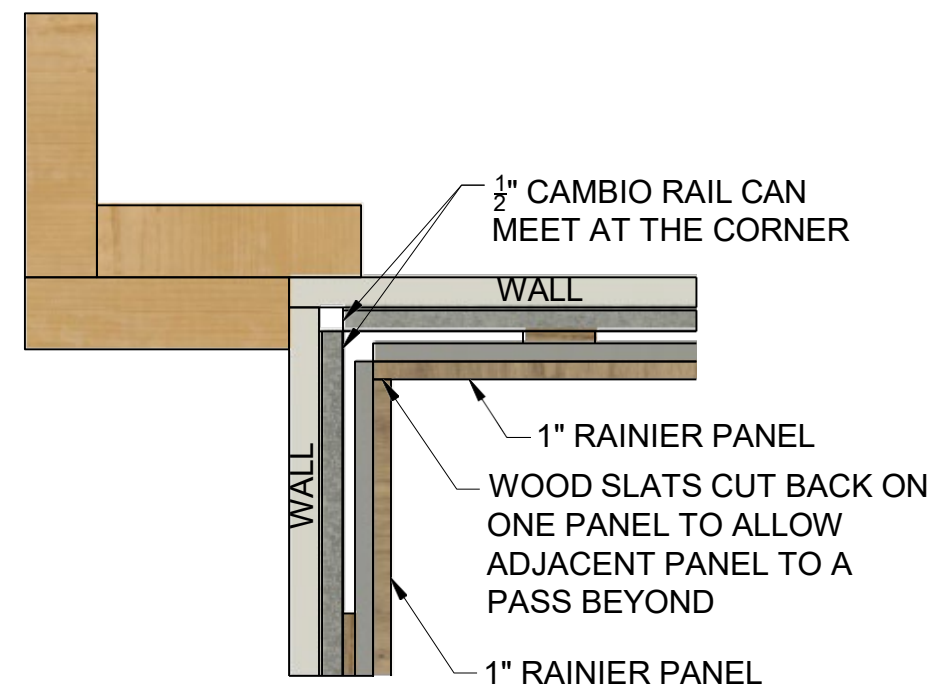

CLIENT

**RAINIER PANEL CORNER DETAILS**  
**RAINIER PANEL TO RAINIER PANEL - INSIDE CORNER**  
**FULL OVERLAP**

SHEET DATA

DRAWN BY:  
Scott Lavis Campbell

SCALE:  
1" = 1'-0"

DATE:  
02/17/2025

PROJECT:  
Rainier Panel Corner

SHEET NUMBER

**8/8**